

10 GOOSE LANE COTTAGES
CHIPPING
PR3 2QF

£219,000



- Stonebuilt 3-storey mews house
- Stunning open views
- 2 double bedrooms
- Lounge with log burner
- Kitchen with appliances
- Private parking for 2 cars
- Beautiful rural setting
- 79 m2 (845 sq ft) approx.

A stonebuilt 3-storey mews house which offers fabulous views across the surrounding Forest of Bowland countryside and Wolf Fell. The building was converted from an original mill worker building in 1998, with the attractive row of properties set in their own grounds and only a short distance from Chipping village which offer a good range of amenities including a pub, school, church and shops.

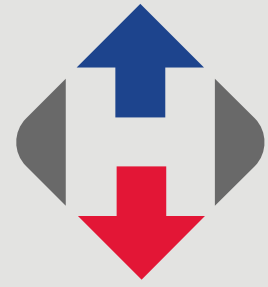

The property has accommodation arranged across 3 floors with a ground floor entrance hall with stairs leading to the first floor. The kitchen is to the front and offers superb views and a range of integrated appliances. The spacious lounge is at the rear with feature central modern log burning stove. On the second floor there are two double bedrooms and a 3-piece bathroom with shower over the bath.

Outside, Goose Lane Cottages is set within its own grounds with lawned areas with a sweeping driveway and visitor parking. Beyond a lawned front garden area, number 10 has its own gravelled driveway providing private parking for 2 cars with planted borders and flowerbeds.

LOCATION: Travelling into Chipping from the Clitheroe/Whalley direction turn left in front of The Sun Inn into Windy Street. Proceed straight on passing the school and as you leave the village carry straight on for half a mile and Goose Lane Cottages are on the left hand side.

ACCOMMODATION: (Imperial dimensions in brackets: all sizes approximate):-

ENTRANCE: Through half-glazed modern PVC front door with corner staircase off to first floor with spindles and balustrade, extensive range of built-in storage cupboards and shelving, understairs cloaks storage area and space for tumble dryer.

FIRST FLOOR:

LANDING: With return staircase off to second floor with good-sized understairs storage cupboard.

LOUNGE: 3.8m x 4.1m (12'7" x 13'3"); with 2 windows, feature central modern cast iron log burner set on glass hearth, television point and laminate flooring.

KITCHEN: 2.9m x 2.4m (9'5" x 7'11"); with a fitted range of white gloss wall and base units with dark wood effect laminate work surface and tiled splashback with under unit lighting, one-and-a-half bowl stainless steel sink unit with mixer tap, integrated electric fan oven with 4-ring ceramic hob with extractor over, integrated fridge, freezer and washing machine, recessed spotlighting and stunning views across open countryside towards Wolf Fell.





SECOND FLOOR:

LANDING: With spindles and balustrade, loft access and recessed spot lighting.

BEDROOM ONE: 3.9m x 3.3m (12'8" x 10'11"); with 2 windows to front elevation offering excellent views across the Forest of Bowland countryside towards Wolf Fell.

BEDROOM TWO: 3.9m x 2.3m (12'9" x 7'6"); with 2 windows.

BATHROOM: 3-piece white suite comprising a low suite w.c. with push button flush, wall-hung wash-hand basin with chrome mixer tap, panelled bath with thermostatic shower over, glass screen, fully tiled walls, tall chrome heated ladder style towel rail, tiled floor and airing cupboard housing hot water cylinder.

OUTSIDE: Goose Lane Cottages is set within its own grounds with a sweeping driveway leading to each property. There are communal visitor parking bays, bin stores and lawned areas.

No.10 has its own gravelled driveway providing private parking for 2 cars, bordered by flowerbeds and a front lawn.



HEATING: Economy 7 heating system with log burner in the lounge and PVC double glazed windows.

SERVICES: Mains water, electricity and drainage are connected. Gas is not available in this location.

COUNCIL TAX BAND D.

EPC: The energy efficiency rating for this property is D.

TENURE: The 4 properties within this section of the building (Numbers 10-16) own the freehold collectively. Each of the properties has been granted a 999 year lease with no ground rent. The 4 properties have 1 building's insurance policy which is split 4 ways. Within the complex of Goose Lane Cottages there are 13 properties, each pay £15.00 per month towards the upkeep of the communal lawned areas, bins store and visitor parking bays.

VIEWING: By appointment with our office.

SELLING YOUR OWN HOUSE? We will be happy to provide free valuation and marketing advice, without obligation - please ask for details.



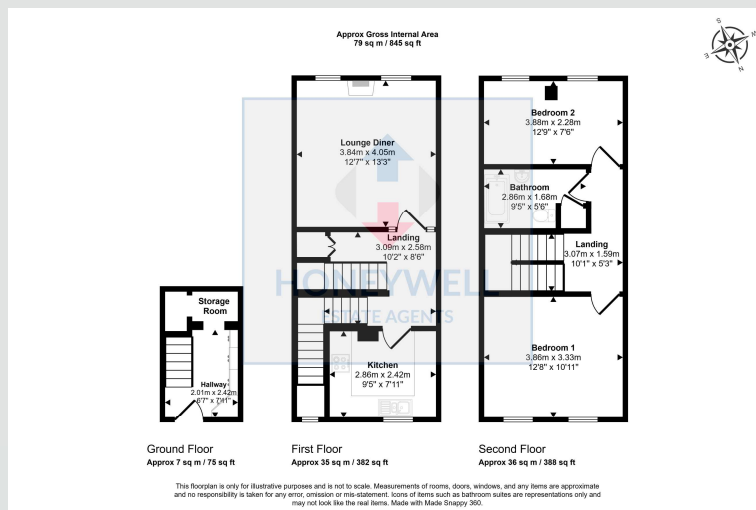

10 Goose Lane Cottages, Chipping, PR3 2QF
CD/CJ/010925

Selling Your House? We will be happy to provide free valuation and marketing advice, without obligation - please ask for details

1 Castlegate, Clitheroe. BB7 1AZ
T: 01200 426041 E: houses@honeywell.co.uk



HoneywellEstateAgents

HoneywellAgents

honeywell.co.uk

Please note: These particulars are produced in good faith, but are intended to be a general guide only and do not constitute any part of an offer or contract. No person in the employment of Honeywell Estate Agents Ltd has any authority to make any representation or warranty whatsoever in relation to the property. Photographs are reproduced for general information and do not imply that any item is included for sale with the property.